

INSTRUCTIONS FOR INSTALLATION

Casting frame - ready to install

Ordering

When ordering, please state the type of casting frame and the exterior measurements. Please, let us be responsible for the fitting of the mat or grid by ordering the casting frame and mat or grid at the same time. Always remember to give the measurements in the order A x B.

A= width left to right.

B= front to back (walking direction).

Please contact us for more information.

Ready to install

Turn the lugs in the desired direction before casting. The top of the concrete has to be in the same level as the top of the standing flange. The finished surface in the bottom of the frame shall be in level with the top of the lower flange.

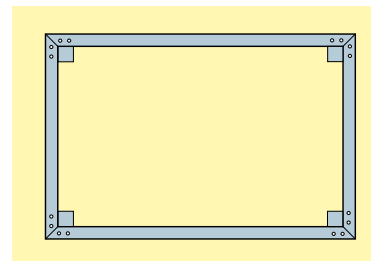
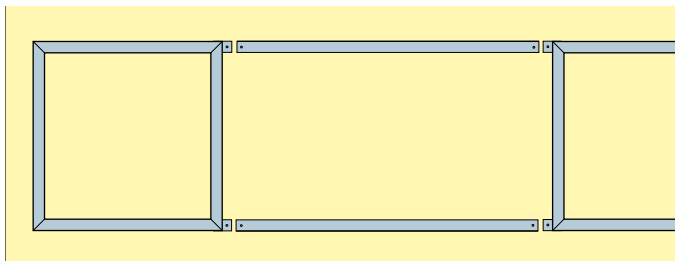

Examples on how bigger frames can be provided.

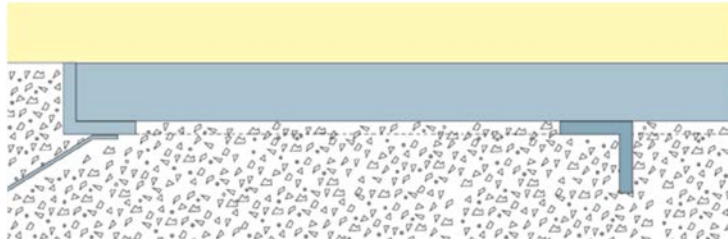

Casting frame with strut to avoid getting hourglass shape of the frame.

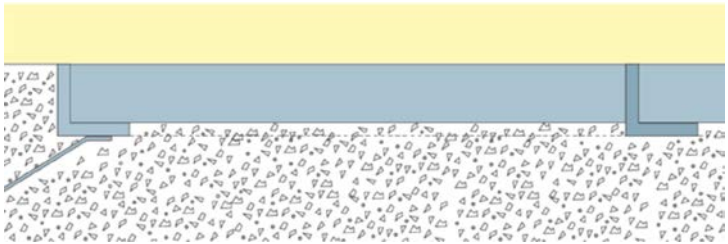

Casting frame with dividing strut.

Profiles

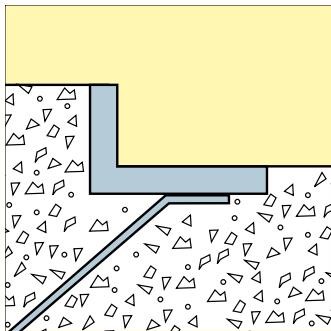

Kabe 12R

For mats height 10-14 mm.
Profile 16 x 26 x 4 mm.

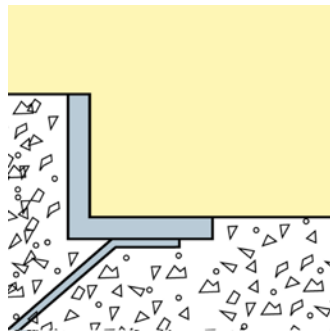

Kabe 17R

For mats and gratings height
15-20 mm.
Profile 20 x 20 x 3 mm.

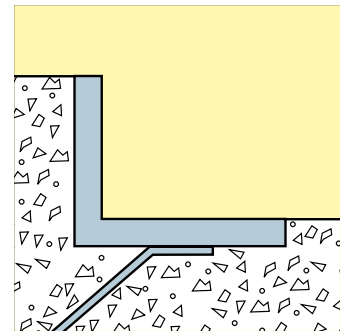

Kabe 20R

For mats and gratings height
20-22 mm.
Profile 25 x 31 x 4 mm.

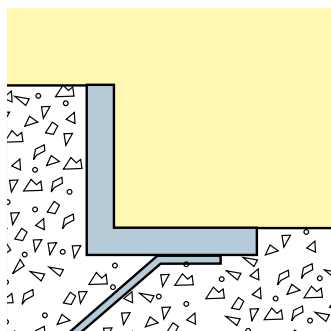

Kabe 22R

For mats and gratings height 2-22 mm.
Profile 25 x 25 x 3 mm.

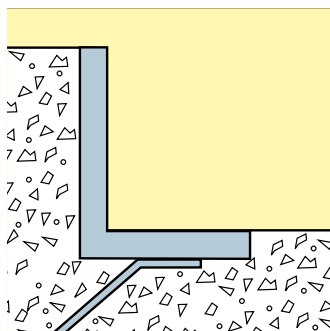

Kabe 25R

For mats and gratings height 25 mm.
Profile 31 x 25 x 4 mm.